

The background is a grayscale photograph of a large industrial machine, likely a coffee roaster, with various pipes, valves, and a control panel. Three red coffee beans are positioned in the upper left, with dashed red lines connecting them to the machine's components. A large, stylized red number '3' is located on the right side of the image.

**AIR-MOTION**

**QUICK  
SPECIFICATIONS  
OVERVIEW**



## AIR-MOTION 3 QUICK SPECIFICATIONS OVERVIEW

- Operator has total, full-variation control of convection and conduction heat transfer via a patented OCR "Open Chamber Roasting" fluid-bed 3kg Air-Roasting chamber.
- All electric | No fuel | No afterburner needed.
- Extremely low emissions | Environmentally smart.
- Achieve a clean, consistent roast - every time.

## CAPACITY / OUTPUT

**Batch Size:** Max 3kg roasting capacity.

**Roast Time:** 12 minutes (dependent on roast level).

**Output:** Max 9kg/hour; 72kg/day (based on 8-hour day).

## DATA LOGGING

**Internal:** 5 real-time graphs: bean temp, heater temp, RoR bean temp, RoR heater temp, and saved profile curve line.

## CONTROL POINTS

- Integrated touchscreen control panel.
- Presetting profile parameters.
- Fast-reacting thermocouples.
- Quick-response heat transfer.
- Speed controller to adjust bean lifting height during roasting.

**Single-Phase:** 230V // 50 Hz // 53 Amps

**Three-Phase:** 400V // 50 Hz // 36 Amps

## COMPONENTS

**Air Flow:** High-efficiency 2 kW heater blower.

**Cooling:** Optional 30-40 second water dousing system for high-speed bean cooling.

**Extraction:** Centrifugal type extraction fan (2.2 kW 1ph, 1.3 kW 3ph) immediately moves dust, smoke, chaff and other impurities from the Open Roast Chamber (OCR).

**Heating:** 10.5 kW Nichrome plated electrical spiral elements.

**Roast Chamber:** Stainless steel construction, durable, easy cleaning.



**Air-Motion  
Roasters are  
manufactured  
to the highest  
quality  
standards**

## Get in touch

Mike:  
+27 (0)82 600-7105  
[mike@air-motionroasters.com](mailto:mike@air-motionroasters.com)



Ross:  
+27 (0)73 513 8383  
[ross@air-motionroasters.com](mailto:ross@air-motionroasters.com)



## Soical Links



[www.air-motionroasters.com](http://www.air-motionroasters.com)

## DIMENSIONS AND WEIGHT: AIR-MOTION 3 ROASTER COMPONENTS

To allow for best space planning, measurements account for the widest, tallest, and deepest parts of components (e.g. touchscreen arm, casters, etc.).

COMPONENT	RAW UNCRATED WEIGHT	DIMENSIONS (L x W x H)
Roast Chamber	71 KG	719mm L x 828mm W x 1227 H
Cyclone	81 KG	1046mm L x 690mm W x 1918 H
Cooling Tray	35 KG	695mm L x 610mm W x 429 H
<b>TOTAL</b>	<b>187 KG</b>	

## DIMENSIONS AND WEIGHT: AIR-MOTION 3 ROASTER CRATING

CRATE	CRATED WEIGHT	CRATE DIMENSIONS (L x W x H)
Crate #1	See note below.	2050mm L x 1230mm W x 96mm H
Crate #2	See note below.	900mm L x 770mm W x 133mm H
<b>TOTAL</b>	<b>250 KG</b>	

**NOTE:** Weight provided is total weight for both crates. Individual crate weights will be received prior to shipping.

## AIR-MOTION 3 CYCLONE VENTING DIAMETER

Exit Pipe Diameter: 147mm Outside Diameter of aluminum flex pipe: 150mm (3mm wall thickness).

## DIMENSIONS AND WEIGHT: AIR-MOTION 3 ROASTER COMPONENTS

To allow for best space planning, measurements account for the widest, tallest, and deepest parts of components (e.g. touchscreen arm, casters, etc.).

COMPONENT	RAW UNCRATED WEIGHT	DIMENSIONS (L x W x H)
Roast Chamber	71 KG	719mm L x 828mm W x 1227 H
Cyclone	81 KG	1046mm L x 690mm W x 1918 H
Cooling Tray	35 KG	695mm L x 610mm W x 429 H
<b>TOTAL</b>	<b>187 KG</b>	

## DIMENSIONS AND WEIGHT: AIR-MOTION 3 ROASTER CRATING

CRATE	CRATED WEIGHT	CRATE DIMENSIONS (L x W x H)
Crate #1	See note below.	2050mm L x 1230mm W x 96mm H
Crate #2	See note below.	900mm L x 770mm W x 133mm H
<b>TOTAL</b>	<b>250 KG</b>	

**NOTE:** Weight provided is total weight for both crates. Individual crate weights will be received prior to shipping.

## AIR-MOTION 3 CYCLONE VENTING DIAMETER

Exit Pipe Diameter: 147mm

Outside Diameter of aluminum flex pipe: 150mm (3mm wall thickness).

## MAINTENANCE

The only maintenance required is the emptying of the Chaff Collector Bucket every couple of days depending on the frequency of roasting and the wiping down of the Roast Chamber with a wet cloth after completion of roasting schedule for the day.

## REPLACEMENT PARTS (IF NEEDED)

The only parts that may need to be replaced due to natural wear and tear:

- Blower fan
- Element bank

Contact Air-Motion Roasters to purchase replacement parts.

## DECIBEL READING

Between 65 dB and 85 dB

## CERTIFICATIONS

CE approved and built to UL standards, IEC (International Electrotechnical Commission)

## SERVICING

No servicing is required other than the Maintenance Schedule as listed.

## WARRANTY

AMR provides a 2-year warranty on all machine parts.

## EMISSION TESTING

Emission testing report included in User Manual.

## REQUIRED CLEARANCES

Position roaster at least 500mm from walls or other equipment, and allow for at least 800mm in front of roaster for user operation.

## AIR-MOTION 3 ROASTER LAYOUT

See next 3 pages for 3kg AMR roast chamber, cooler tray, and cyclone weight, layout, and dimensions.



## AIR-MOTION 3: ROAST CHAMBER

WEIGHT: 71 kg

NOTE: The AMR 3 roaster comes on casters to allow for easy positioning and cleaning.  
Below measurements are provided in millimeters (mm).

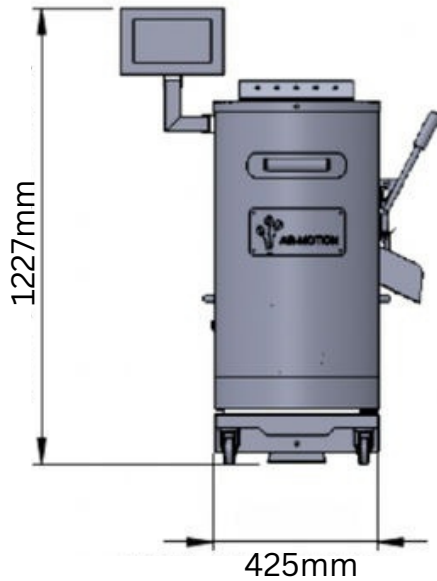

FRONT VIEW

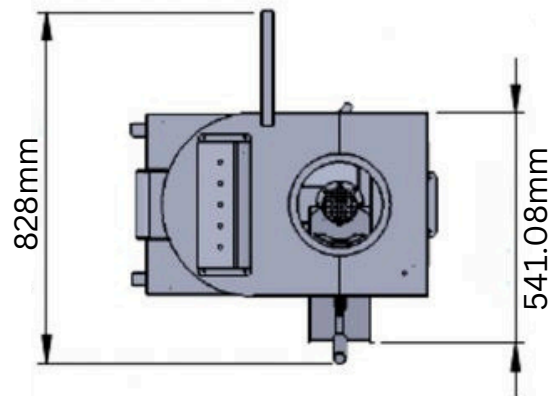

TOP VIEW

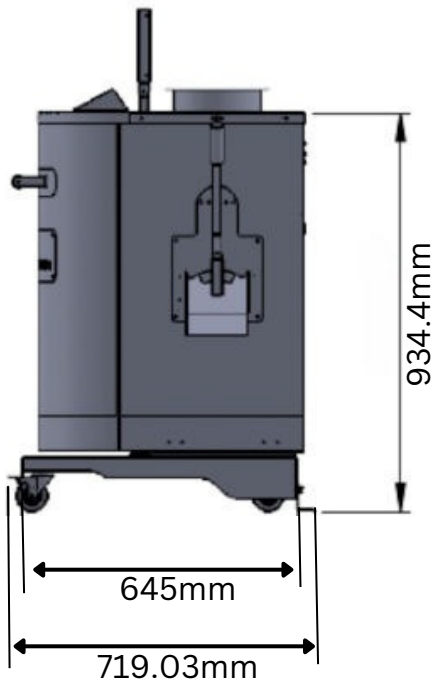

SIDE VIEW

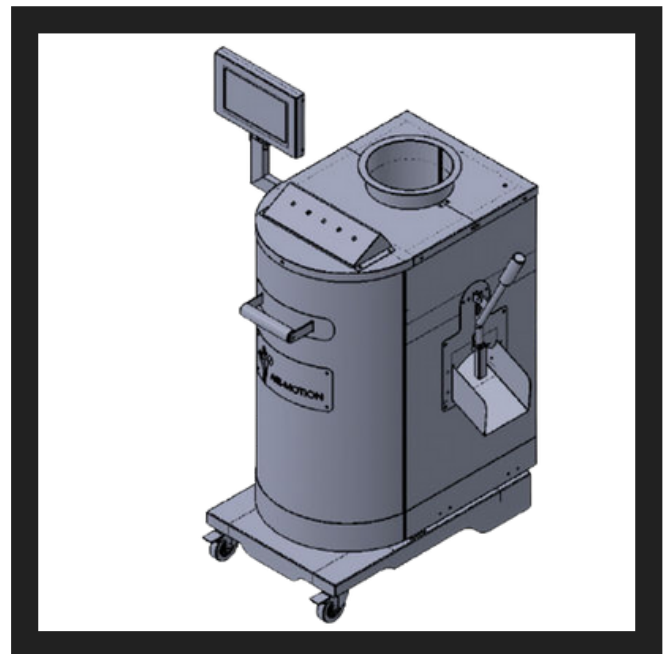



## AIR-MOTION 3: COOLING TRAY

WEIGHT: 35 kg

Below measurements are provided in inches, feet, and millimeters (mm).

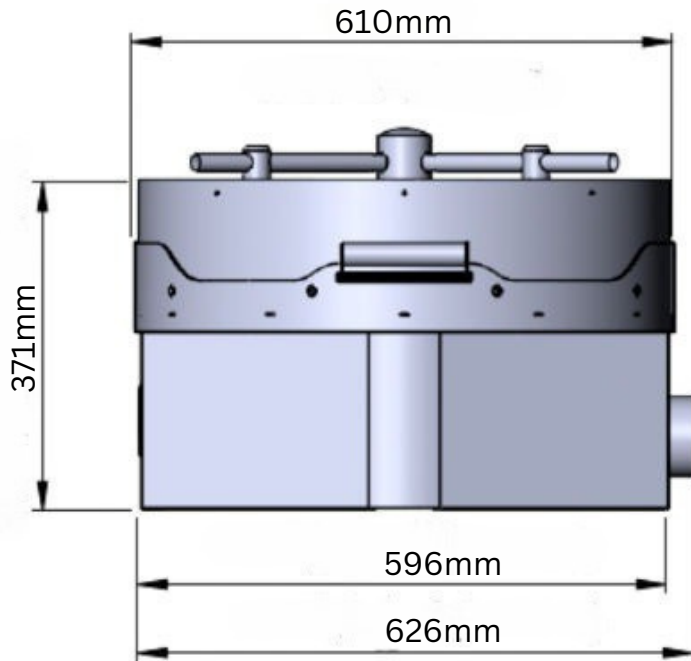

FRONT VIEW

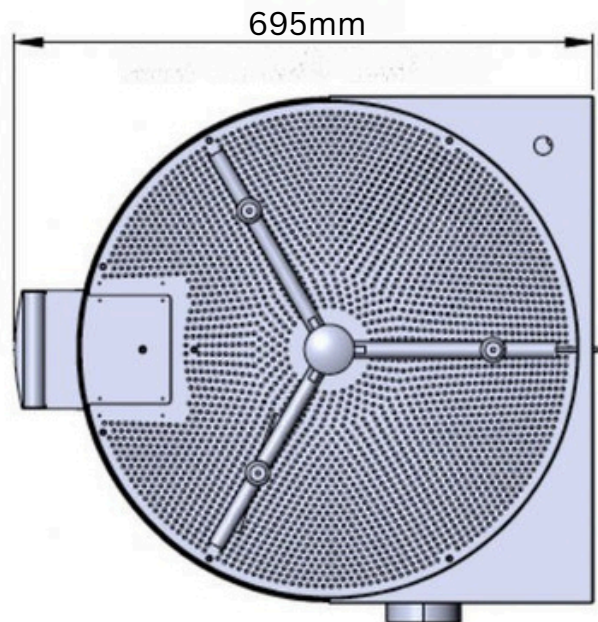

TOP VIEW

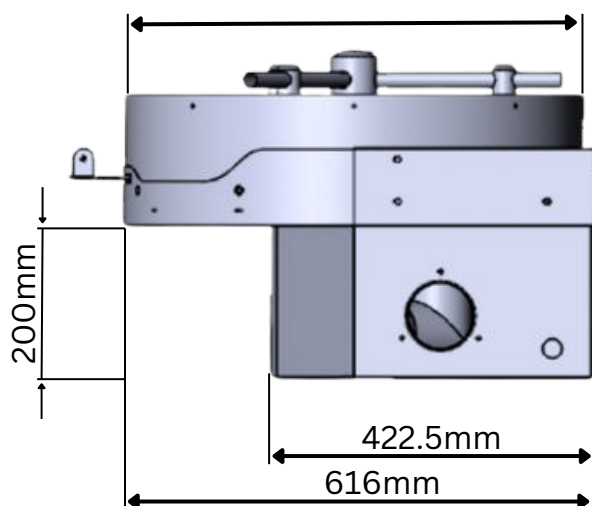

SIDE VIEW

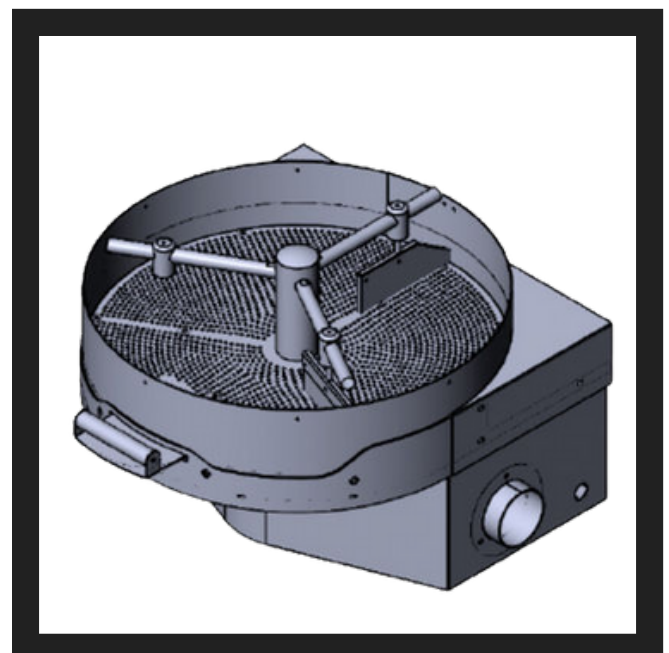

## AIR-MOTION 3: CYCLONE

WEIGHT: 178.5 kg

Below measurements are provided in inches, feet, and millimeters (mm).

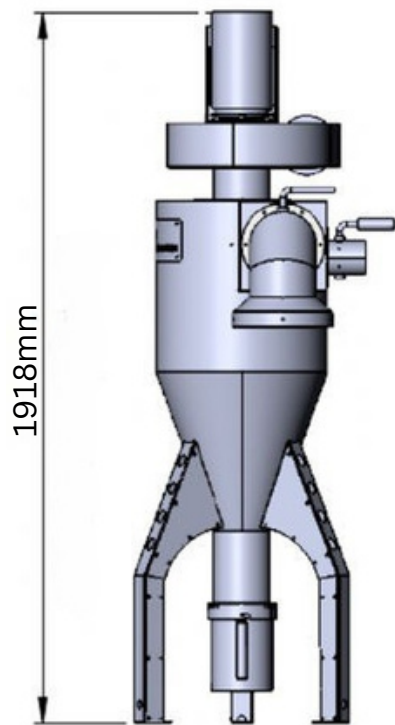

FRONT VIEW

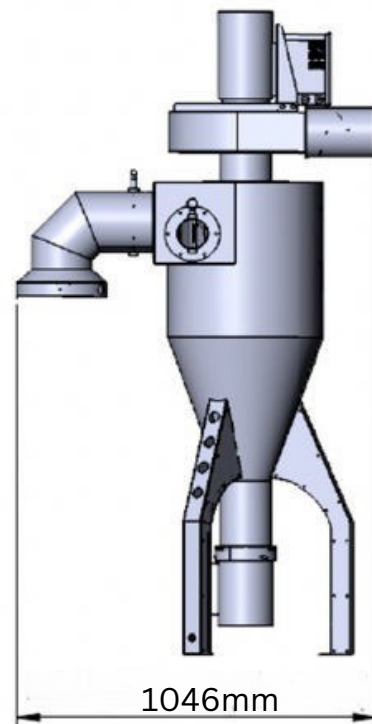

SIDE VIEW

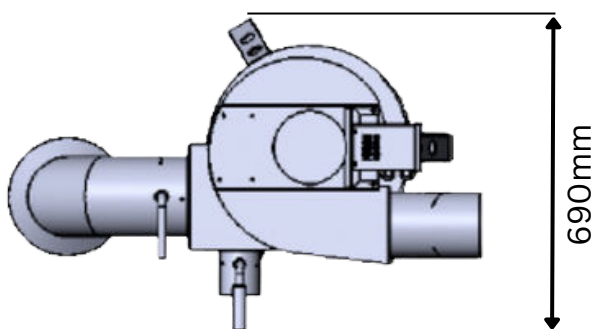

TOP VIEW

